

## Channels Sections

Die: **2715**

**Trim Section**

Min. Order Qty Mtrs: 1,675

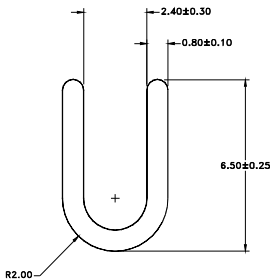

Die: **3830**

**5.70 x 4.50 Channel**

Min. Order Qty Mtrs: 1,475

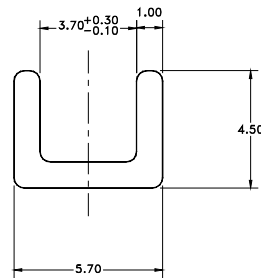

Die: **4006**

**FG51 "C" Channel**

Min. Order Qty Mtrs: 1,425

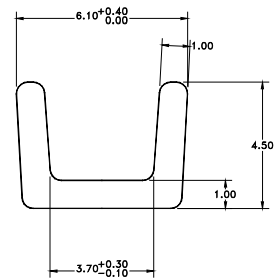

Die: **5407**

**7.0 x 5.0 x 1.0mm Grout Chann**

Min. Order Qty Mtrs: 1,225

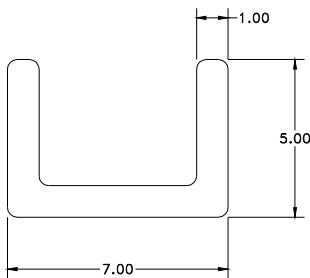

Die: **5098**

**Stacker Door upstand cover c**

Min. Order Qty Mtrs: 1,025

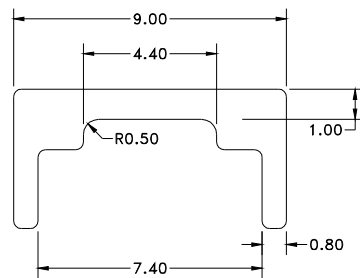

Die: **2885**

**Edge Trim**

Min. Order Qty Mtrs: 925

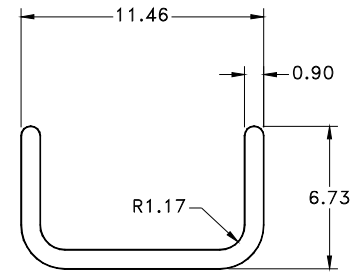

Die: **3949**

**6mm Reflector**

Min. Order Qty Mtrs: 925

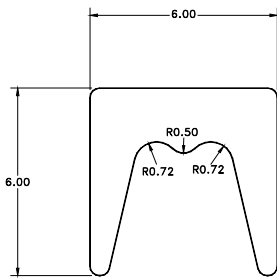

Die: **5142**

**Stile Insert**

Min. Order Qty Mtrs: 875

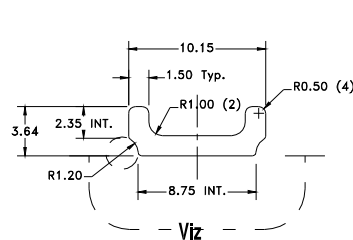

Die: **4281**

**9.0mm Spacer**

Min. Order Qty Mtrs: 725

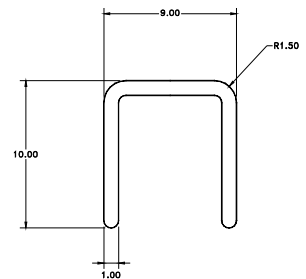

Die: **1274**

**INFIL BEAD**

Min. Order Qty Mtrs: 725

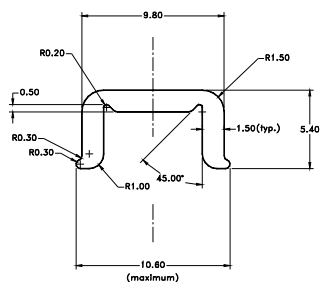

Die: **1155**

**10 x 10 x 1mm Channel**

Min. Order Qty Mtrs: 675

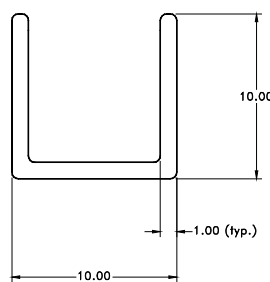

Die: **3165**

**U Section**

Min. Order Qty Mtrs: 575

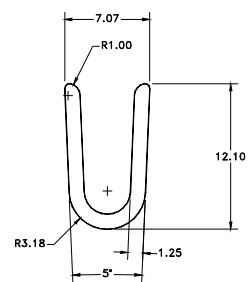

**Aluminium Extrusion Co**  
A Division of Parkin Metal Moulding Co Ltd

P 04 388 1091 F 04 388 1191  
7-14 Southampton Road Miramar  
Wellington 6022

# Channels Sections

Die: **2567**  
**(M1633) Section DA32SP**  
 Min. Order Qty Mtrs:575

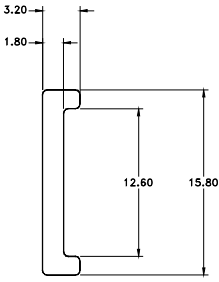

Die: **4081**  
**7.60mm Channel**  
 Min. Order Qty Mtrs:525

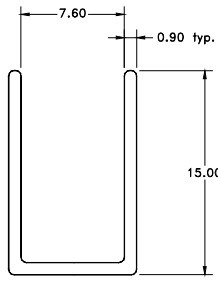

Die: **3936**  
**M1633 DA33 SP**  
 Min. Order Qty Mtrs:525

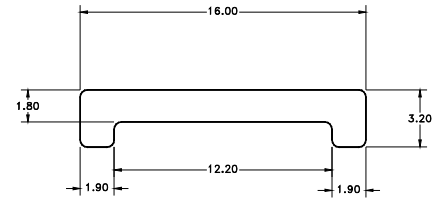

Die: **3753**  
**Channel**  
 Min. Order Qty Mtrs:525

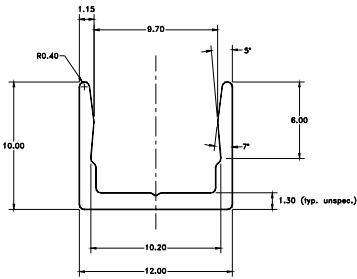

Die: **1139**  
**15 x 6.5 x 1.4mm Channel**  
 Min. Order Qty Mtrs:525

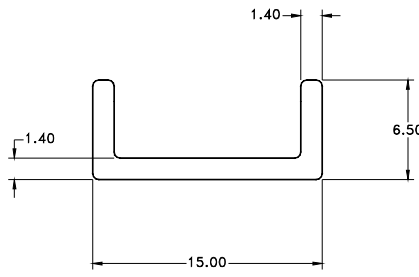

Die: **2939**  
**Sail Track**  
 Min. Order Qty Mtrs:475

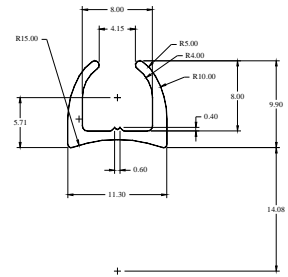

Die: **833**  
**FLYSCREEN NO.14**  
 Min. Order Qty Mtrs:475

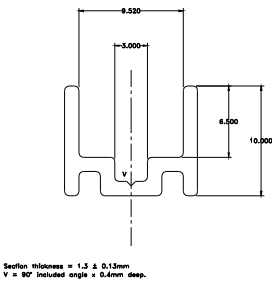

Die: **352**  
**1/4" GLASS CHANNEL**  
 Min. Order Qty Mtrs:475

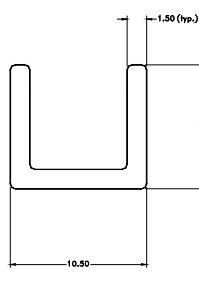

Die: **52**  
**3/8" x 3/8" x 1/16" Channel**  
 Min. Order Qty Mtrs:475

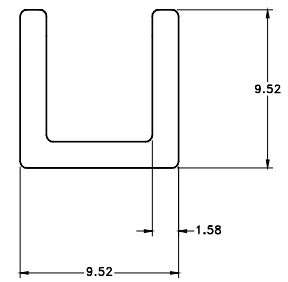

Die: **774**  
**LIBRARY STRIPPING**  
 Min. Order Qty Mtrs:475

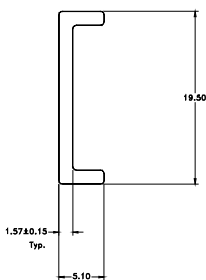

Die: **5097**  
**Capping Channel 11mm insid**  
 Min. Order Qty Mtrs:475

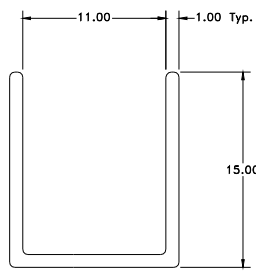

Die: **4650**  
**Channel 8.7 x 11.5**  
 Min. Order Qty Mtrs:425

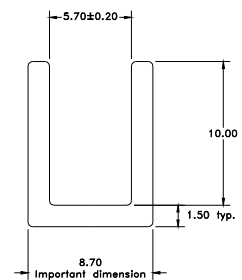

## Channels Sections

Die: **3592**

**15.0 x 12.0 mm Channel**

Min. Order Qty Mtrs:425

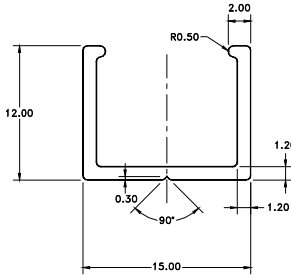

Die: **4868**

**25.7 inside x 5.25 Channel**

Min. Order Qty Mtrs:425

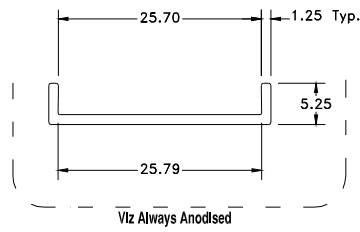

Die: **4521**

**2150 Alu Channel**

Min. Order Qty Mtrs:425

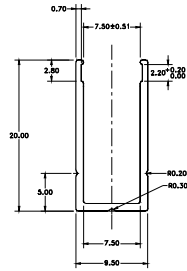

Die: **1627**

**C SECTION**

Min. Order Qty Mtrs:375

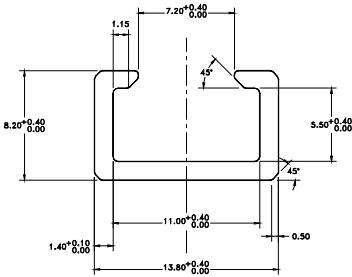

Die: **3572**

**Rail**

Min. Order Qty Mtrs:375

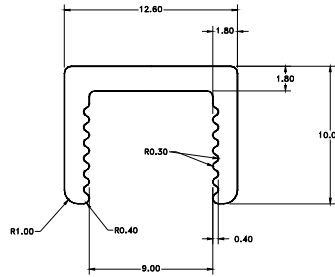

Die: **778**

**Channel B (MO29)**

Min. Order Qty Mtrs:375

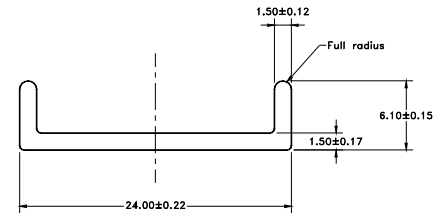

Die: **3997**

**M1720 Front End Plate**

Min. Order Qty Mtrs:375

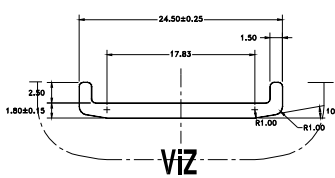

Die: **3932**

**M1720 Fore End Plate**

Min. Order Qty Mtrs:375

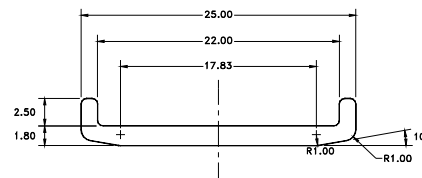

Die: **2747**

**16.0 x 7.0mm Channel**

Min. Order Qty Mtrs:375

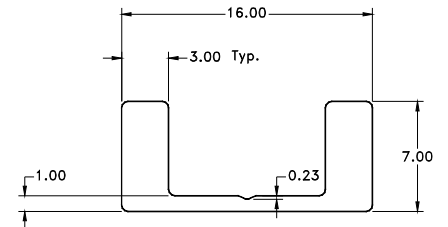

Die: **3633**

**Channel Section**

Min. Order Qty Mtrs:325

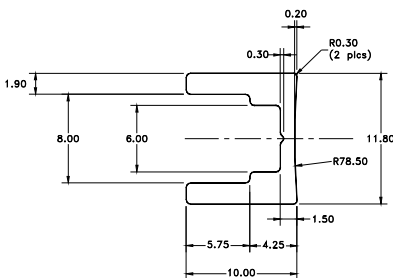

Die: **766**

**Channel 'A' (MO28)**

Min. Order Qty Mtrs:325



Die: **2020**

**9.52 x 12.7mm Channel**

Min. Order Qty Mtrs:325

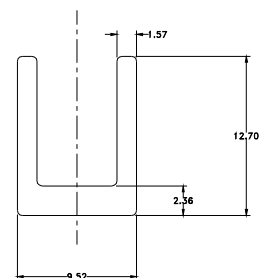

**Aluminium Extrusion Co**

A Division of Parkin Metal Moulding Co Ltd

P 04 388 1091 F 04 388 1191

7-14 Southampton Road Miramar

Wellington 6022

# Channels Sections

Die: **3758**

**Channel**

Min. Order Qty Mtrs:325

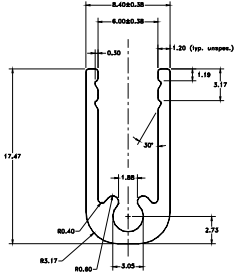

Die: **3057**

**20mm Channel**

Min. Order Qty Mtrs:325

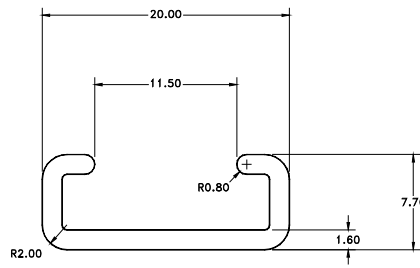

Die: **3978**

**Channel PL 2104-16**

Min. Order Qty Mtrs:325

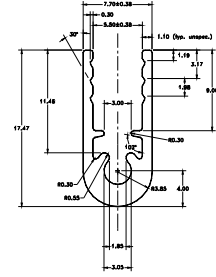

Die: **4653**

**Flat Bar Front Shelf 303 (5470)**

Min. Order Qty Mtrs:325

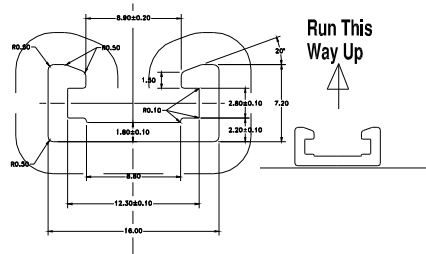

Die: **95**

**500 Rail Bottom**

Min. Order Qty Mtrs:325

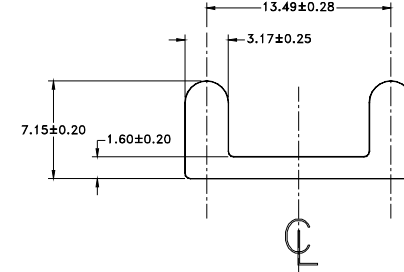

Die: **4466**

**CS20-015 XPF**

Min. Order Qty Mtrs:325

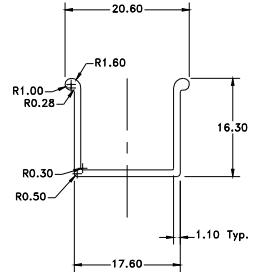

Die: **834**

**FLYSCREEN SECTION 1415**

Min. Order Qty Mtrs:275

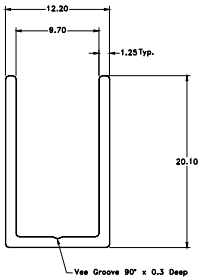

Die: **3475**

**Section 12A218000**

Min. Order Qty Mtrs:275

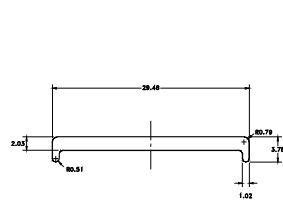

Die: **726**

**Channel**

Min. Order Qty Mtrs:275

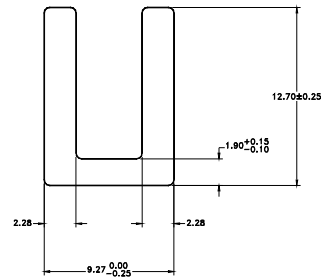

Die: **4507**

**Roman Wall-Fix Centre Suppo**

Min. Order Qty Mtrs:275

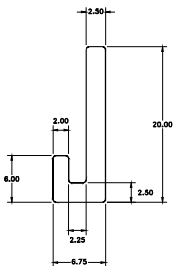

Die: **3043**

**Deep Web Channel**

Min. Order Qty Mtrs:275

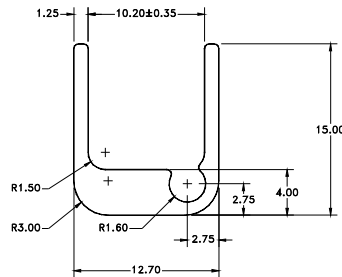

Die: **3831**

**40.5 x 11.0 Channel**

Min. Order Qty Mtrs:275

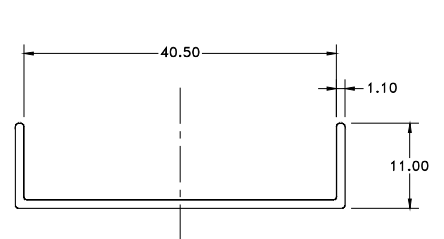

**Aluminium Extrusion Co**  
A Division of Parkin Metal Moulding Co Ltd

P 04 388 1091 F 04 388 1191  
7-14 Southampton Road Miramar  
Wellington 6022

# Channels Sections

Die: **1314**

**(M054) LM3**

Min. Order Qty Mtrs:275

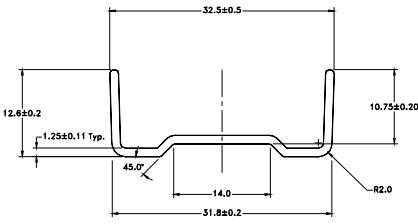

Die: **3759**

**Channel**

Min. Order Qty Mtrs:275

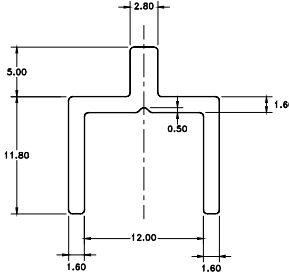

Die: **5376**

**Roller Housing for 32mm Squ**

Min. Order Qty Mtrs:275

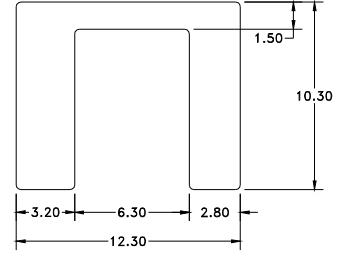

Die: **3026**

**Channel**

Min. Order Qty Mtrs:275

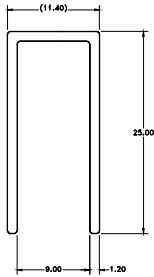

Die: **3574**

**3 Leg Channel**

Min. Order Qty Mtrs:275

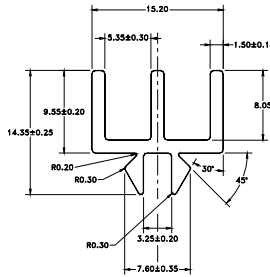

Die: **3573**

**Channel**

Min. Order Qty Mtrs:275

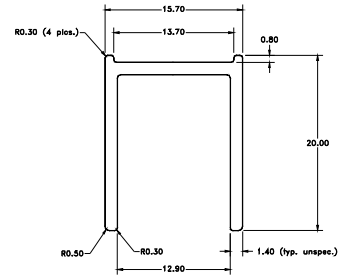

Die: **4267**

**Racking Strip**

Min. Order Qty Mtrs:225

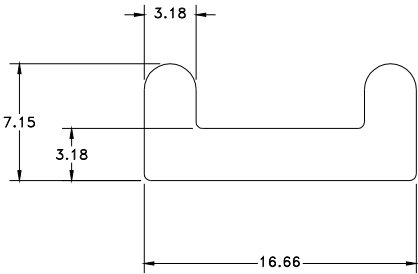

Die: **5291**

**25mm Head Box**

Min. Order Qty Mtrs:225

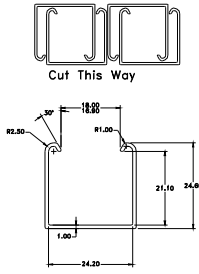

Die: **1638**

**25mm HEAD BOX**

Min. Order Qty Mtrs:225

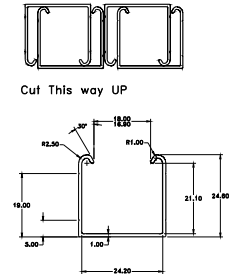

Die: **3283**

**Q007 Return Wall Retainer**

Min. Order Qty Mtrs:225

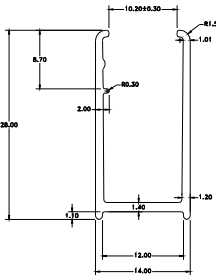

Die: **2360**

**25mm CHANNEL**

Min. Order Qty Mtrs:225

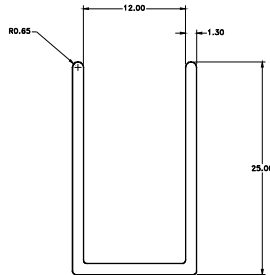

Die: **5157**

**Flagtrax Single Joints CNCT5**

Min. Order Qty Mtrs:225

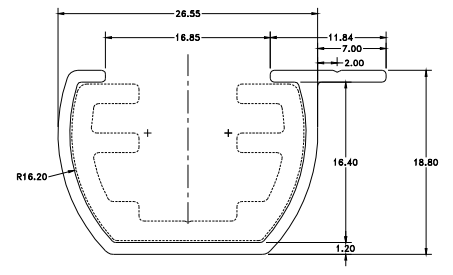

# Channels Sections

Die: **4279**

**30.0 x 14.3mm Channel**

Min. Order Qty Mtrs:225

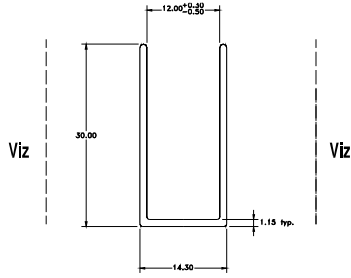

Die: **5138**

**16.0mm Ultra Top Fix Bracket**

Min. Order Qty Mtrs:225

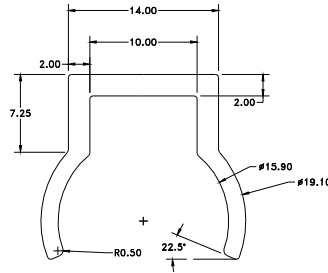

Die: **4564**

**CS11 Pocket Filler (for Cs10)**

Min. Order Qty Mtrs:225

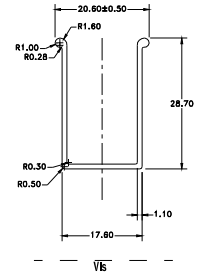

Die: **5004**

**Track**

Min. Order Qty Mtrs:225

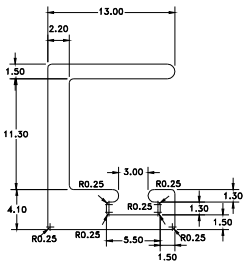

Die: **3189**

**12.3 x 19.0 x 2.0mm Channel**

Min. Order Qty Mtrs:225

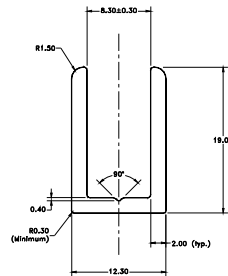

Die: **2806**

**Shower Screen Jamb**

Min. Order Qty Mtrs:225

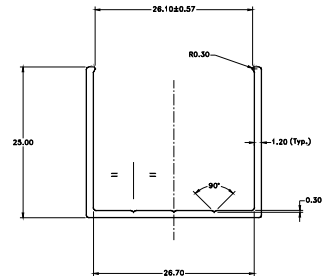

Die: **2597**

**Rail**

Min. Order Qty Mtrs:175

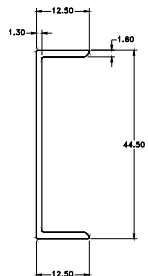

Die: **3473**

**Wall Channel**

Min. Order Qty Mtrs:175

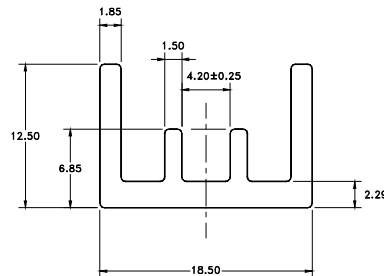

Die: **1762**

**WALL CHANNEL**

Min. Order Qty Mtrs:175

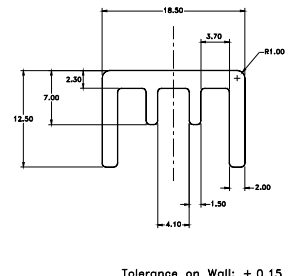

Die: **1628**

**SHELF RACK**

Min. Order Qty Mtrs:175

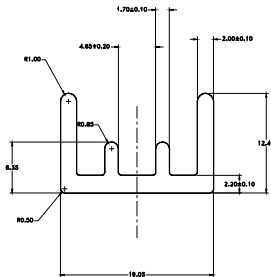

Die: **4935**

**CS - 33**

Min. Order Qty Mtrs:175

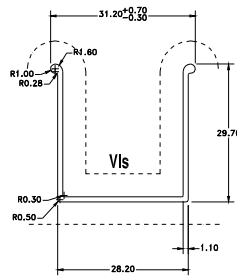

Die: **2666**

**12A GFS Centre Plate**

Min. Order Qty Mtrs:175

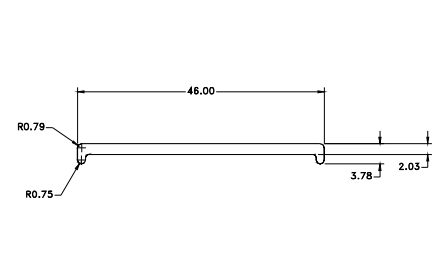

# Channels Sections

Die: 3336

**ZAD030 Ali Door T-Guide Cha**

Min. Order Qty Mtrs: 175

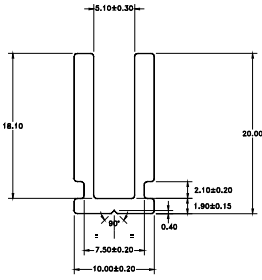

Die: 2840

**Screen Jamb (Legged)**

Min. Order Qty Mtrs: 175

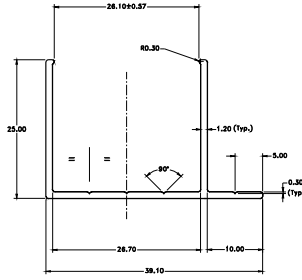

Die: 4495

**C. Channel**

Min. Order Qty Mtrs: 175

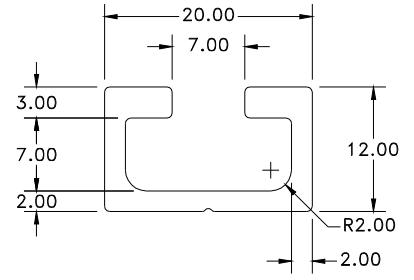

Die: 3689

**Top Rail**

Min. Order Qty Mtrs: 175

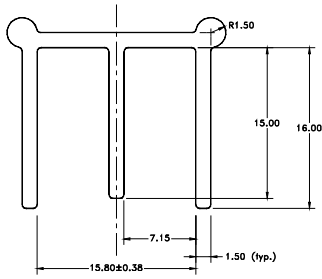

Die: 3627

**Rotofore End Plate**

Min. Order Qty Mtrs: 175

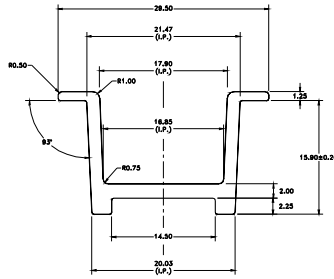

Die: 87

**5/8" x 5/8" POINTED CHANNE**

Min. Order Qty Mtrs: 175

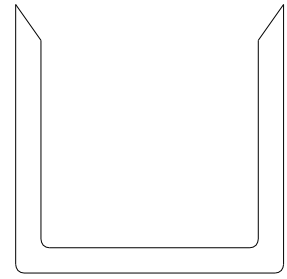

Die: 3187

**48.6 x 20 x 1.3mm Channel**

Min. Order Qty Mtrs: 175

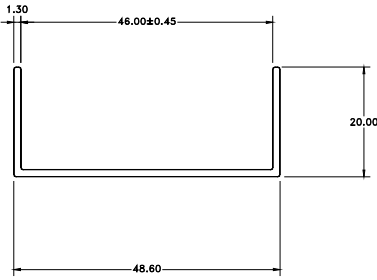

Die: 3812

**DIP**

Min. Order Qty Mtrs: 175

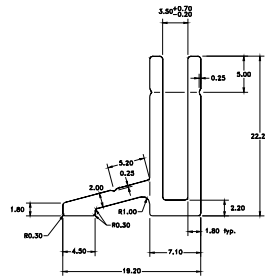

Die: 92

**1" x 1" x 1/16" Channel**

Min. Order Qty Mtrs: 175

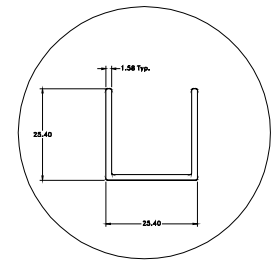

Die: 3866

**26.2 x 24.0mm Channel**

Min. Order Qty Mtrs: 175

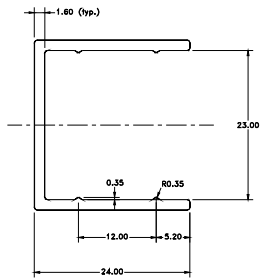

Die: 1109

**(M046) SECTION V27 (V.8.)**

Min. Order Qty Mtrs: 175

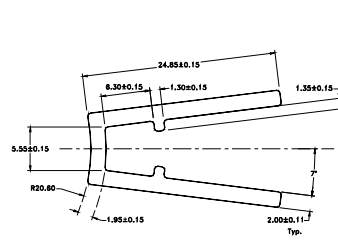

Die: 3078

**Door 'U' Section**

Min. Order Qty Mtrs: 175

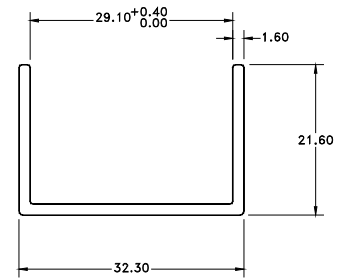

# Channels Sections

Die: **4491**

**Door Edge**

Min. Order Qty Mtrs: 125

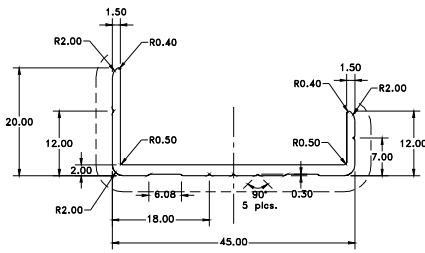

Die: **4473**

**Channel 12.4 x 20 x 2.7**

Min. Order Qty Mtrs: 125

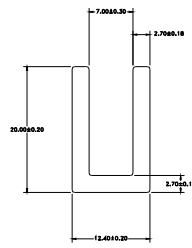

Die: **3609**

**19.0 x 35.0mm Channel**

Min. Order Qty Mtrs: 125

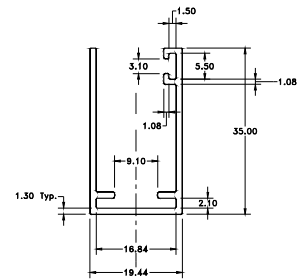

Die: **5671**

**Low Profile Track**

Min. Order Qty Mtrs: 125

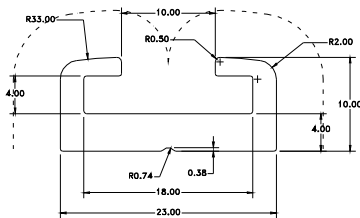

Die: **4061**

**Channel**

Min. Order Qty Mtrs: 125

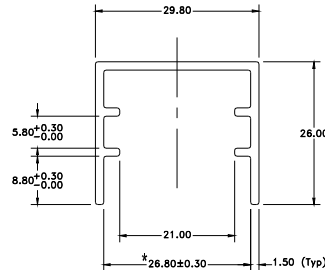

Die: **5196**

**Weather Shield Ganz**

Min. Order Qty Mtrs: 125

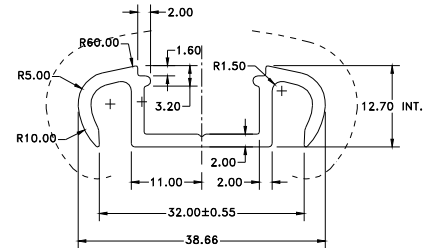

Die: **4523**

**25.3 x 17.0 x 2.5mm Channel**

Min. Order Qty Mtrs: 125

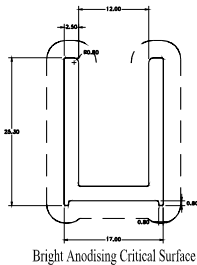

Die: **3341**

**Wall Mount Channel**

Min. Order Qty Mtrs: 125

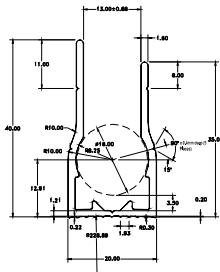

Die: **3660**

**M047 V35**

Min. Order Qty Mtrs: 125

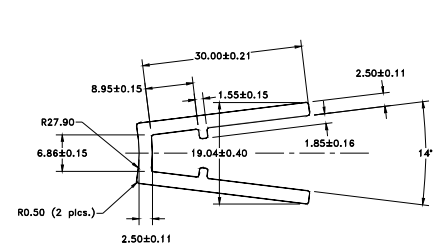

Die: **4963**

**Channel 30 x 25 x 2.5mm**

Min. Order Qty Mtrs: 75

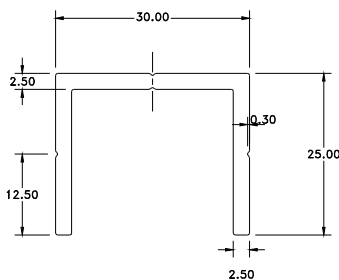

Die: **4261**

**Channel**

Min. Order Qty Mtrs: 75

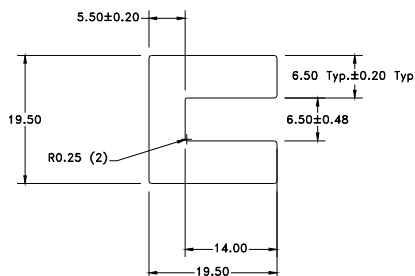

Die: **5197**

**Saddle Bracket**

Min. Order Qty Mtrs: 75

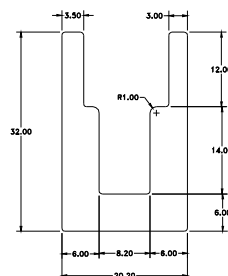

**Aluminium Extrusion Co**  
A Division of Parkin Metal Moulding Co Ltd

P 04 388 1091 F 04 388 1191  
7-14 Southampton Road Miramar  
Wellington 6022