

Angle Sections

Die: 17

BLADE (DG17)

Min. Order Qty Mtrs: 1,075

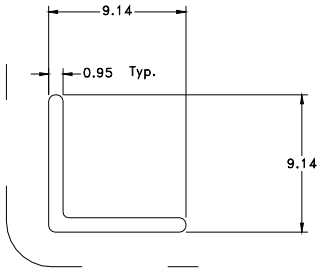

Die: 1566

8mm x 8mm Angle

Min. Order Qty Mtrs: 1,025

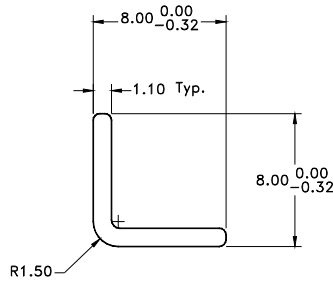

Die: 4242

Wall Flange

Min. Order Qty Mtrs: 975

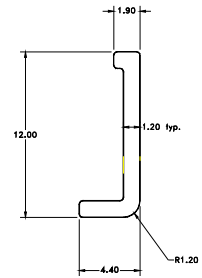

Die: 3299

Ensign Cap (30072)

Min. Order Qty Mtrs: 825

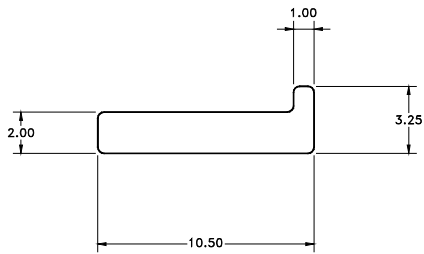

Die: 5595

10 x 8 x 1.5 Angle

Min. Order Qty Mtrs: 725

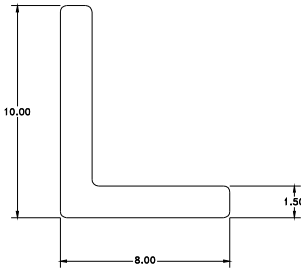

Die: 4630

14.33 x 6.3mm Trim Angle

Min. Order Qty Mtrs: 725

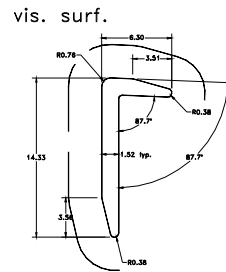

Die: 3460

14.5 x 5 Angle

Min. Order Qty Mtrs: 675

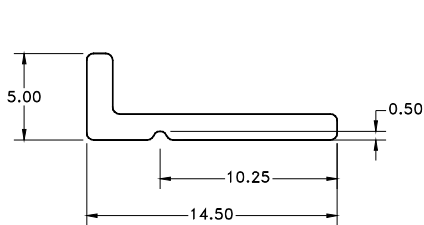

Die: 331

5/8" x 3/8" x .050" Angle

Min. Order Qty Mtrs: 625

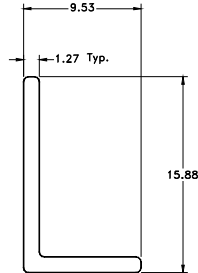

Die: 2746

13.0 x 7.0mm Angle

Min. Order Qty Mtrs: 625

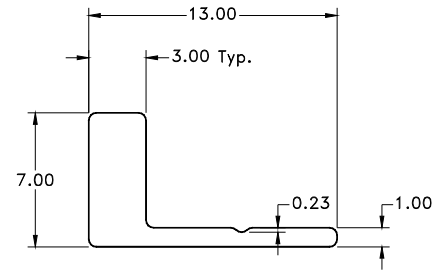

Die: 2192

8.0 x 15.0 x 1.5mm Angle (NZ1)

Min. Order Qty Mtrs: 575

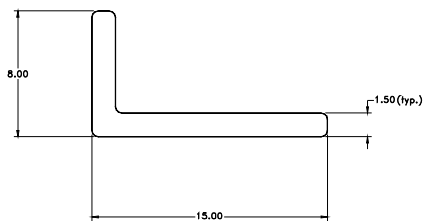

Die: 3005

"J" Section

Min. Order Qty Mtrs: 575

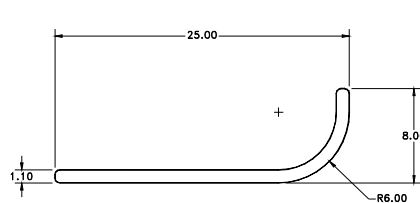

Die: 131

12 x 12 x 1.5mm Angle

Min. Order Qty Mtrs: 525

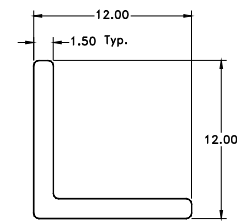

Angle Sections

Die: **3601**

Radius Angle

Min. Order Qty Mtrs:525

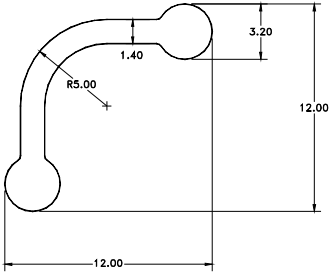

Die: **5**

1/2" x 1/2" 1/16" Angle

Min. Order Qty Mtrs:475

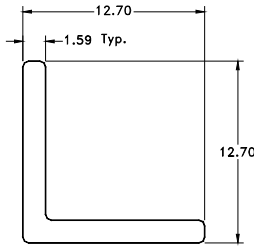

Die: **3867**

MO21 Angle D

Min. Order Qty Mtrs:425

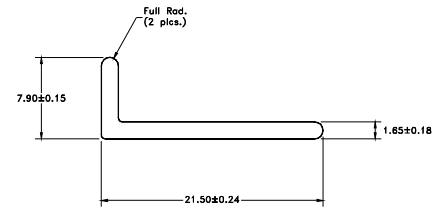

Die: **1097**

20 x 12 x 1.5mm Angle

Min. Order Qty Mtrs:425

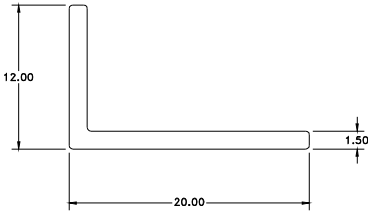

Die: **4862**

L Guide Rail

Min. Order Qty Mtrs:375

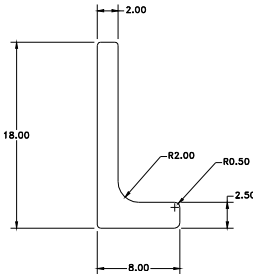

Die: **4241**

Alcove Flange

Min. Order Qty Mtrs:375

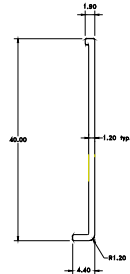

Die: **3305**

Bead

Min. Order Qty Mtrs:325

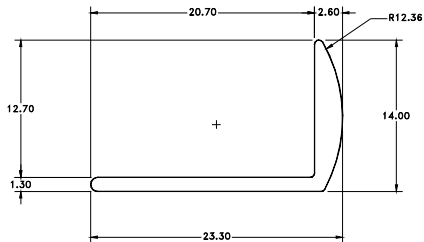

Die: **3787**

Angle 'N' (M1501)

Min. Order Qty Mtrs:325

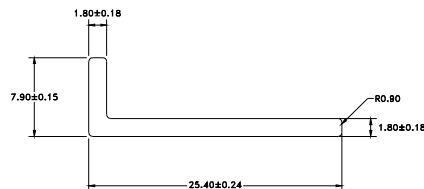

Die: **3253**

Angle E (MO22)

Min. Order Qty Mtrs:325

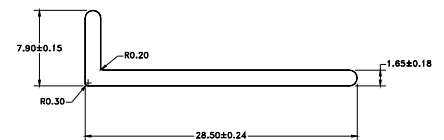

Die: **4950**

Navigator 10 Top/Bottom Angl

Min. Order Qty Mtrs:325

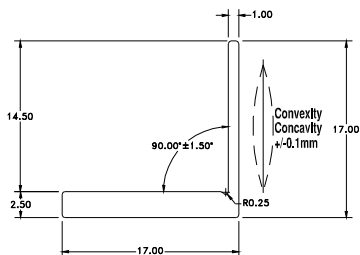

Die: **21**

3/4" x 3/4" x 1/16" Angle

Min. Order Qty Mtrs:325

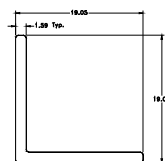

Die: **408**

Angle 'B' (M1419)

Min. Order Qty Mtrs:325

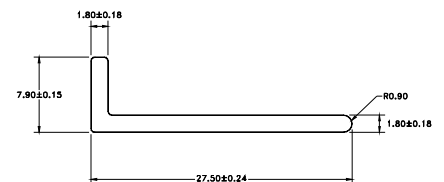

Angle Sections

Die: **4475**

Corner Angle

Min. Order Qty Mtrs:275

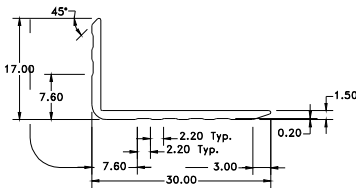

Die: **4303**

22 x 22 x 1.5 Angle

Min. Order Qty Mtrs:275

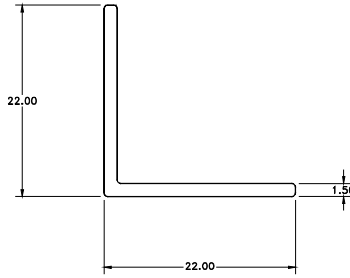

Die: **4057**

20mm Angle

Min. Order Qty Mtrs:275

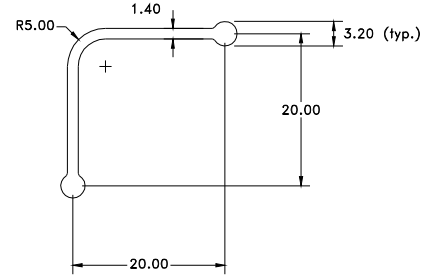

Die: **640**

(M023) ANGLE F (V.3.)

Min. Order Qty Mtrs:275

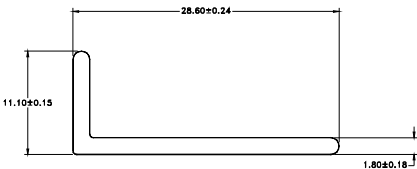

Die: **1406**

Angle 'J' (MO25)

Min. Order Qty Mtrs:275

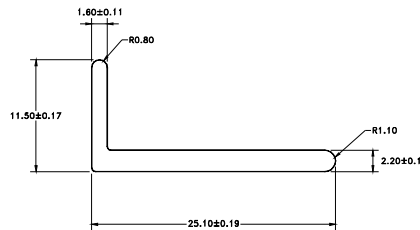

Die: **139**

25 x 25 x 1.5mm Angle

Min. Order Qty Mtrs:275

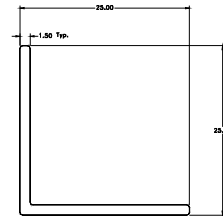

Die: **202**

40 x 12 x 1.5mm Angle

Min. Order Qty Mtrs:225

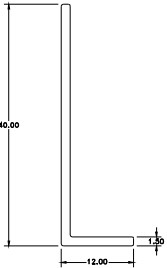

Die: **4304**

25 x 25 x 1.6 Angle

Min. Order Qty Mtrs:225

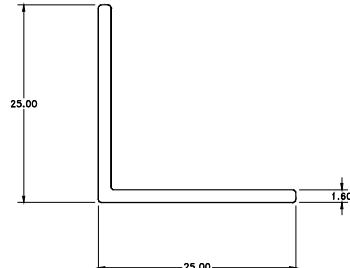

Die: **5699**

Angle Coving

Min. Order Qty Mtrs:225

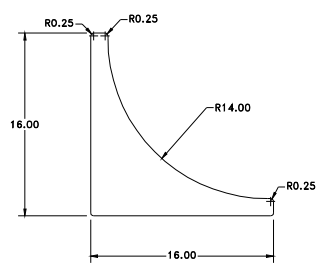

Die: **802**

(M024) ANGLE G (V.4.)

Min. Order Qty Mtrs:225

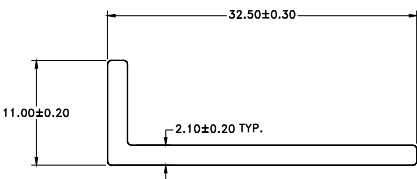

Die: **136**

19 x 19 x 3mm Angle

Min. Order Qty Mtrs:175

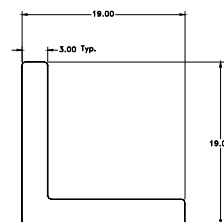

Die: **5651**

40 x 20 x 1.8mm angle

Min. Order Qty Mtrs:175

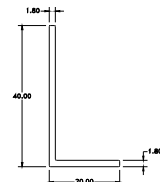

Angle Sections

Die: **2288**

BATTERY PACK FRAME

Min. Order Qty Mtrs: 175

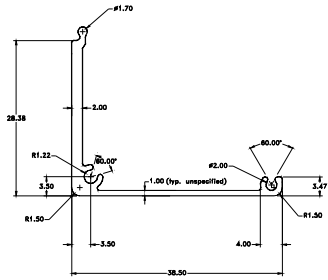

Die: **208**

38 x 38 x 1.5mm Angle

Min. Order Qty Mtrs: 175

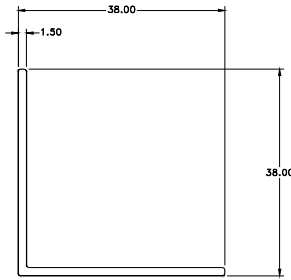

Die: **3868**

CO27892 Channel

Min. Order Qty Mtrs: 175

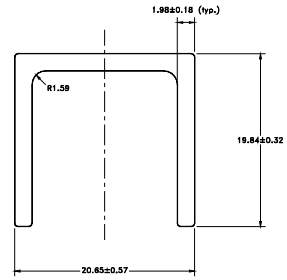

Die: **2631**

22 x 19 x 3 Angle

Min. Order Qty Mtrs: 175

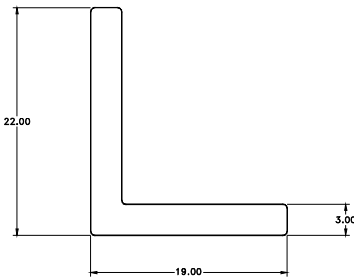

Die: **3886**

Bracket Counter Support 5458

Min. Order Qty Mtrs: 125

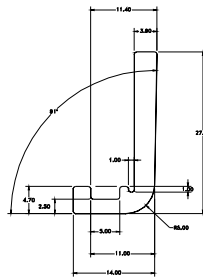

Die: **2660**

25 x 23 x 3.0mm Angle

Min. Order Qty Mtrs: 125

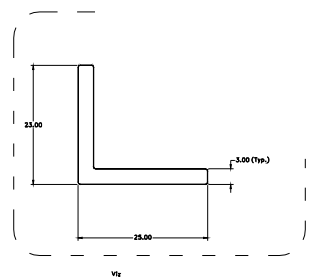

Die: **5656**

Self Intersecting Post

Min. Order Qty Mtrs: 125

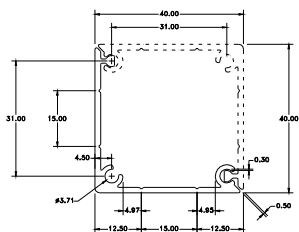

Die: **153**

32 X 32 X 3mm Angle

Min. Order Qty Mtrs: 75

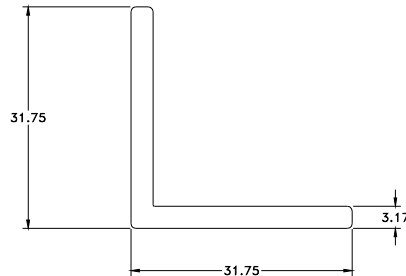

Die: **100**

40 x 40 x 3 Angle

Min. Order Qty Mtrs: 75

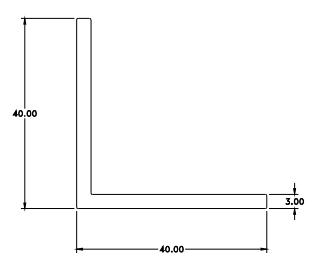

Die: **4260**

26 x 26 Angle

Min. Order Qty Mtrs: 75

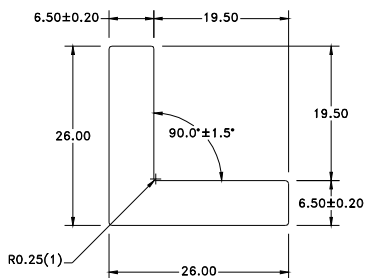

Die: **5260**

Angle 35 x 30 x 10

Min. Order Qty Mtrs: 25

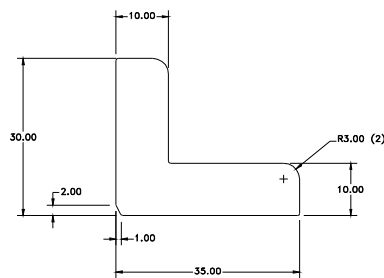

Die: **5261**

Angle 36 x 35 Special

Min. Order Qty Mtrs: 25

